



## Installation Instructions

### 60-0640RB Cover

1) Remove the OEM clutch cover from the motor. Inspect and clean all components before installing the Woodcraft cover.

2) Attach the skid plate to the Woodcraft cover by bolting it from the inside.

**IMPORTANT - USE THREADLOCKING COMPOUND ON THE THREE SKID PLATE MOUNTING BOLTS.** Coat the threads completely and allow the threadlocking compound to fully set before use.

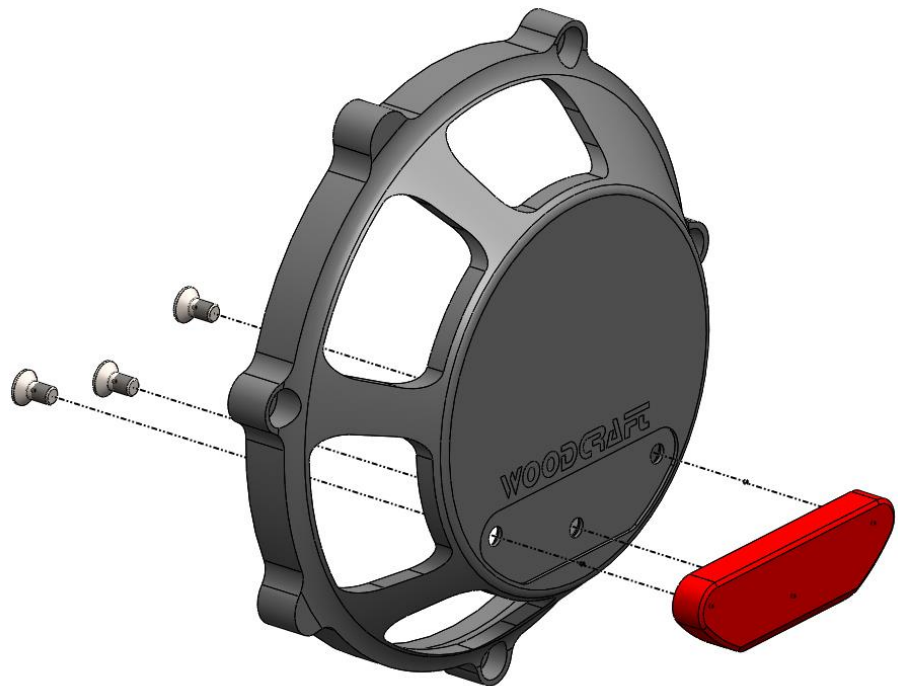

4) Clean the engine gasket surface. The OEM rubber gasket is re-used on the Woodcraft cover.

5) Install the Woodcraft cover using the OEM mounting hardware. Torque according to service manual specifications (standard torque for 6mm hardware is about 8-10 ft lbs).

6) Run the motorcycle and check thoroughly for leaks and proper clutch disengagement before operation.

### **WARNING**

Installation of Woodcraft Billet Covers involves removal and reinstallation of certain factory components such as fasteners, alternator stators and oil-retention gaskets. **FAILURE TO INSTALL THESE COMPONENTS IN COMPLIANCE WITH ALL SPECIFIC INSTRUCTIONS SUPPLIED WITH BILLET COVER KIT MAY CAUSE OIL LOSS OR DAMAGE TO ENGINE RESULTING IN LOSS OF CONTROL OF MOTORCYCLE AND SERIOUS INJURY OR DEATH.**